



TOWN OF ISLESBORO
150 MAIN ROAD, PO BOX 76
ISLESBORO, ME 04848

DISCLAIMER:

WHILE EVERY EFFORT IS MADE TO ENSURE THE ACCURACY OF THESE TAX MAPS, THEY ARE INTENDED FOR ASSESSMENT PURPOSES ONLY. THE TAX MAPS FOR THE TOWN OF ISLESBORO ARE MADE AVAILABLE TO THE PUBLIC, BUT RELIANCE ON ANY INFORMATION CONTAINED THEREIN IS AT THE USER'S OWN RISK. THE TOWN OF ISLESBORO DOES NOT GUARANTEE THE ACCURACY, RELIABILITY, COMPLETENESS OR TIMELINESS OF ANY INFORMATION ON THESE MAPS AND IS NOT LIABLE FOR ANY LOSSES CAUSED BY ANY PERSON'S RELIANCE ON THESE MAPS. ALL COPYRIGHTS AND OTHER RIGHTS TO STATUTORY TEXT ARE RESERVED TO THE TOWN OF ISLESBORO. BUILDING OUTLINES ARE CURRENT TO SPRING 2004.

PREPARED BY:

AERIAL SURVEY AND PHOTO, INC.
546 AIRPORT ROAD PO BOX 659
NORRIDGEWOOD, MAINE 04957
TEL: 207 634-2006

MAINE STATE PLANE COORDINATE GRID
EAST ZONE, NAD 1983; US SURVEY FEET
BASE IMAGERY; SPRING 2004 STATE OF MAINE
DIGITAL ORTHOPHOTOGRAPHY

NOTE:

REC INDICATES ACREAGE AS DENOTED ON PLAN OR DEED OF RECORD.
DIG INDICATES ACREAGE CALCULATED FROM PARCEL BOUNDARIES AS DIGITIZED.

MAP LEGEND

PARCEL NUMBER	17	PARCEL BOUND	—————
PARCEL DIMENSION	161.21'	ROAD RIGHT OF WAY	=====
PARCEL AREA	2.456 AC	EASEMENT LINE	- - - - -
MATCH LABEL	P/O MAP 25 LOT 17	PRIVATE RIGHT OF WAY	—————
MATCHLINE		WETLAND EDGE	~~~~~
SUBDIVISION LOT NUMBER	(24)	BUILDING FOOTPRINT	□

INSET

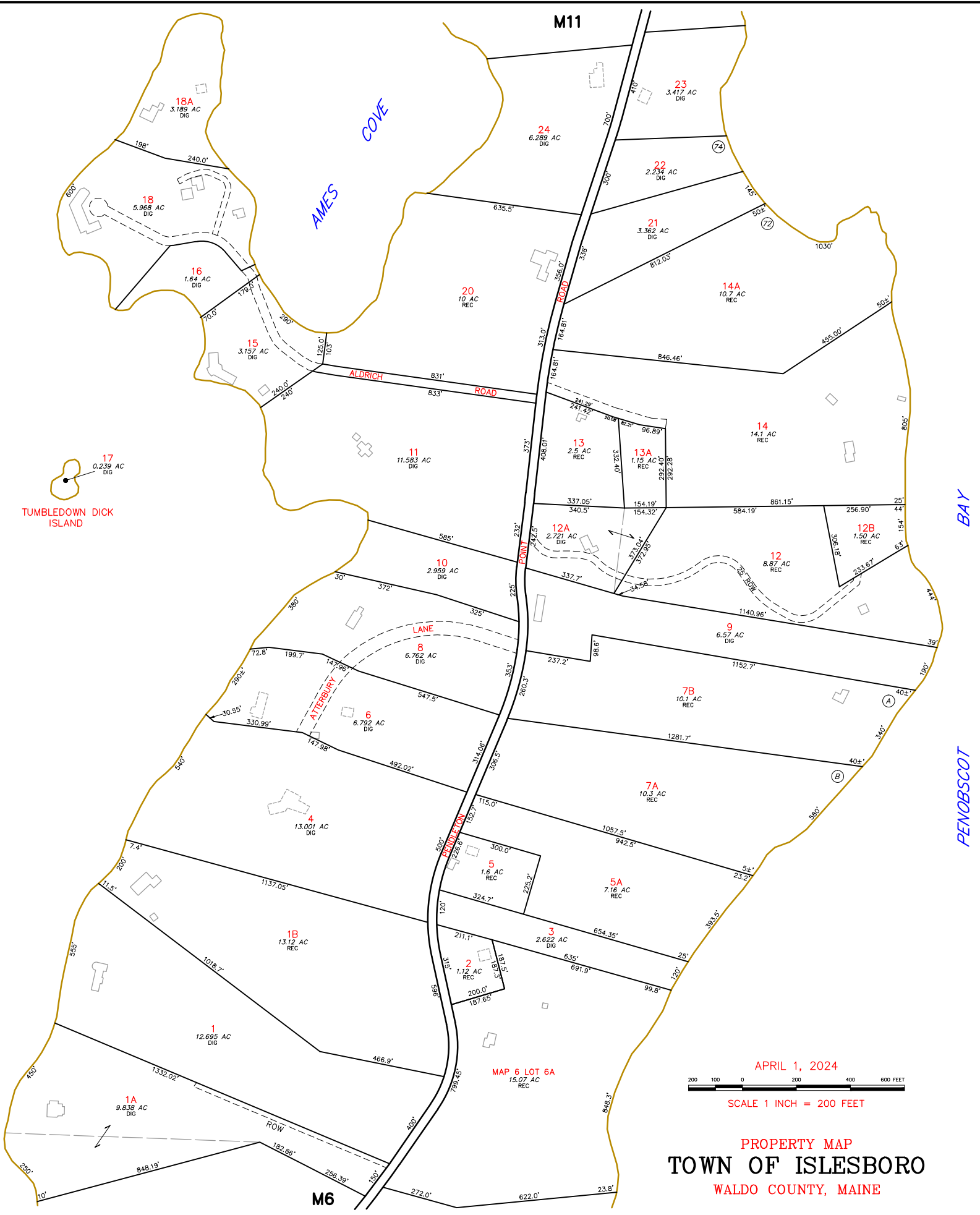
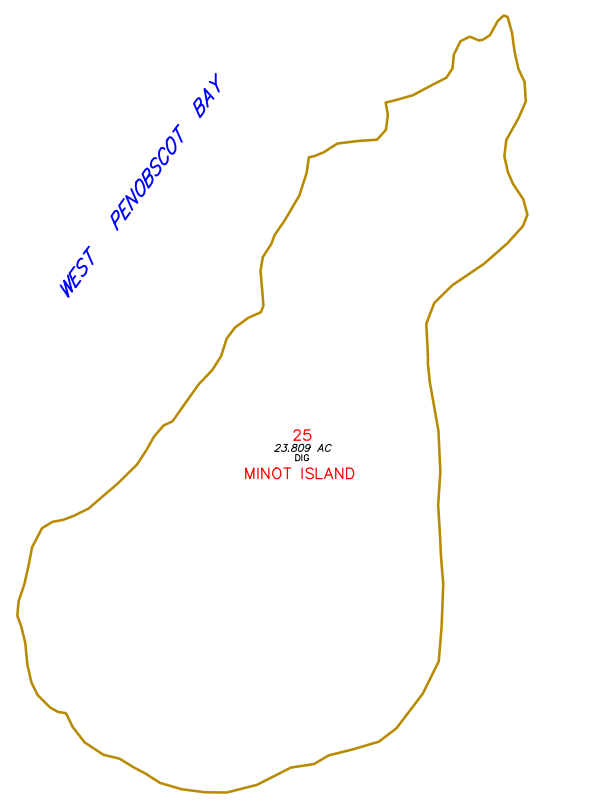

APRIL 1, 2024
SCALE 1 INCH = 200 FEET

PROPERTY MAP
TOWN OF ISLESBORO
WALDO COUNTY, MAINE