



TOWN OF ISLESBORO  
150 MAIN ROAD, PO BOX 76  
ISLESBORO, ME 04848

**DISCLAIMER:**

WHILE EVERY EFFORT IS MADE TO ENSURE THE ACCURACY OF THESE TAX MAPS, THEY ARE INTENDED FOR ASSESSMENT PURPOSES ONLY. THE TAX MAPS FOR THE TOWN OF ISLESBORO ARE MADE AVAILABLE TO THE PUBLIC, BUT RELIANCE ON ANY INFORMATION CONTAINED THEREIN IS AT THE USER'S OWN RISK. THE TOWN OF ISLESBORO DOES NOT GUARANTEE THE ACCURACY, RELIABILITY, COMPLETENESS OR TIMELINESS OF ANY INFORMATION ON THESE MAPS AND IS NOT LIABLE FOR ANY LOSSES CAUSED BY ANY PERSON'S RELIANCE ON THESE MAPS. ALL COPYRIGHTS AND OTHER RIGHTS TO STATUTORY TEXT ARE RESERVED TO THE TOWN OF ISLESBORO. BUILDING OUTLINES ARE CURRENT TO SPRING 2004.

**PREPARED BY:**

AERIAL SURVEY AND PHOTO, INC.  
546 AIRPORT ROAD PO BOX 659  
NORRIDGEWICK, MAINE 04957  
TEL: 207 634-2006

MAINE STATE PLANE COORDINATE GRID  
EAST ZONE; NAD 1983; US SURVEY FEET  
BASE IMAGERY; SPRING 2004 STATE OF MAINE  
DIGITAL ORTHOPHOTOGRAPHY

**NOTE:**

**REC** INDICATES ACREAGE AS DENOTED ON PLAN OR DEED OF RECORD.  
**DIG** INDICATES ACREAGE CALCULATED FROM PARCEL BOUNDARIES AS DIGITIZED.

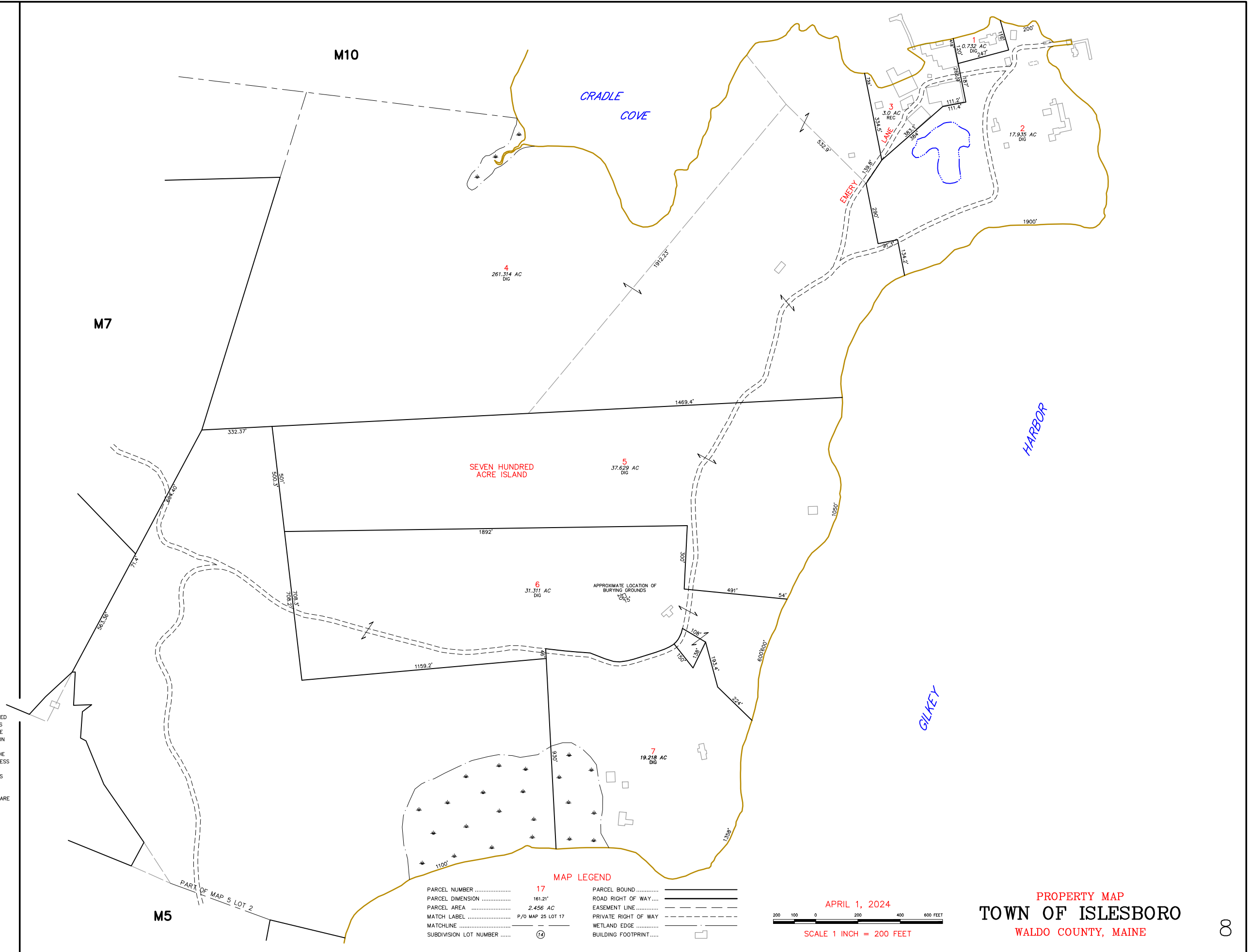

**MAP LEGEND**

PARCEL NUMBER .....	17	PARCEL BOUND .....	———
PARCEL DIMENSION .....	161.21'	ROAD RIGHT OF WAY .....	====
PARCEL AREA .....	2.456 AC	EASEMENT LINE .....	- - - -
MATCH LABEL .....	P/O MAP 25 LOT 17	PRIVATE RIGHT OF WAY .....	———
MATCHLINE .....	②	WETLAND EDGE .....	~~~~~
SUBDIVISION LOT NUMBER .....	②	BUILDING FOOTPRINT .....	□

APRIL 1, 2024  
SCALE 1 INCH = 200 FEET

PROPERTY MAP  
**TOWN OF ISLESBORO**  
WALDO COUNTY, MAINE